

## Stripline Edge Launch Pin .019" Diameter Flat Tab DC to 27 GHz

### Werbel Interconnect Technical Data Sheet

### JP27-.019

#### Description

Model JP27-.019 from Werbel Microwave is stripline launch pin designed for use with field replaceable connectors that accept a .019-inch nominal diameter launch pin. One side is dome-shaped to facilitate easy insertion into the respective connector. The flat tab is mounted to the pc board edge by soldering.

Use with field replaceable SMA-Female, Werbel **JC27-SF-.019**.

Use with field replaceable N-Female, Werbel **JC18-NF-.019**.



Photo is representative.

Specifications <i>(Valid only when used with connector)</i>	Min.	Typ.	Max.	Units
Frequency	0		27,000	MHz
Impedance		50		Ohm
Package Qty	100			pcs
VSWR		1.10		:1
Input Power (CW) <sup>1</sup>			30	Watts

#### Mechanical

Connector Interface	Socket Contact
Operating Temperature <sup>2</sup>	-55 to +100 °C
Storage Temperature	-55 to +100 °C
Weight Estimate	3.4 mg
Humidity	10-90% non-condensing
Environment	Indoor Use Only

#### Materials

RoHS and REACH Compliant <sup>3</sup>	
Body	Beryllium Copper (BeCu)
Finish	Gold Flashed

1. All output ports should be terminated in a 50-ohm load with 1.2:1 max VSWR.
2. Electrical Specifications at +25 °C only.
3. To the best of our knowledge at the time of publication.

## Installation Instructions

The following serves as a general guide and shall not be taken as professional advice of any kind.

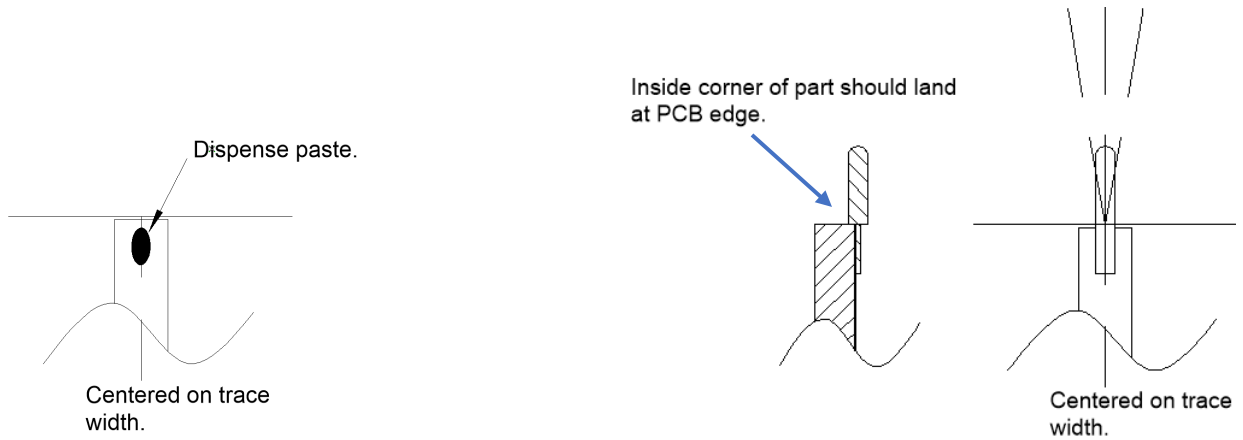

## Proper Installation Techniques



## Outline Dimensions

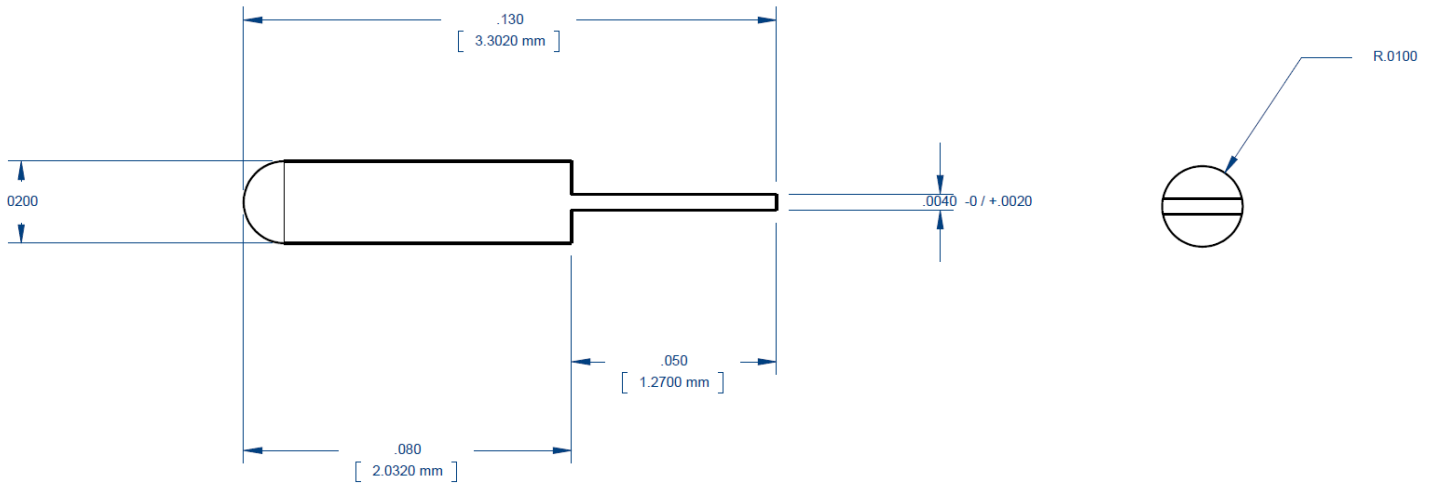

Outline # J-PIN-.019

Dimensions are in inches, [mm] shown for convenience.

Tolerances on 2-pl decimals:  $\pm .03$ . 3-pl decimals:  $\pm .015$ .

## Packaging Example



The information contained in this document is accurate to the best of our knowledge and representative of the part described herein. It may be necessary to make modifications to the part and/or documentation of the part, in order to implement improvements. Werbel Microwave LLC reserves the right to make such changes as required without notice. Unless otherwise stated, all specifications and dimensions are nominal. Werbel Microwave does not make any representation or warranty regarding the suitability of the part described herein for any particular purpose, and Werbel Microwave LLC does not assume any liability arising out of the use of any part of documentation. This document gives only a description of the product(s) and shall not form part of any contract. Please contact a Werbel Microwave LLC Applications Engineer for the most current specification drawing.