

Dimensions

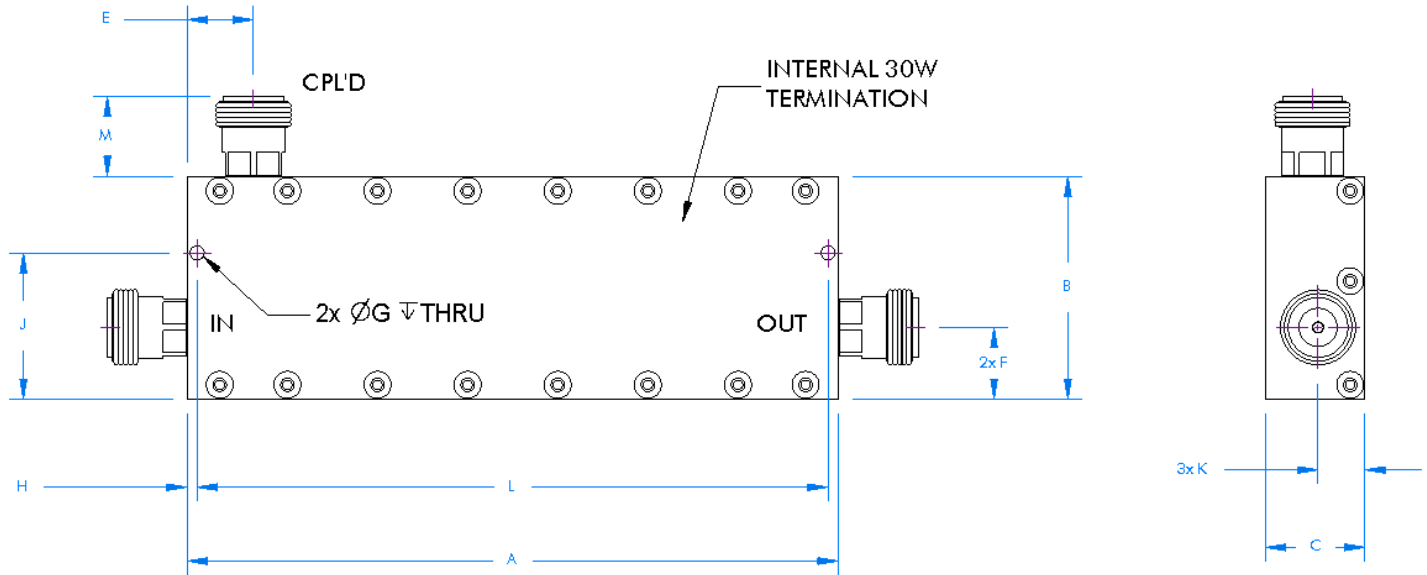

Dim	A	B	C	D	E	F	G	H	J	K	L	M	N	P
Inch	5.78	1.98	0.88	-	0.59	0.64	0.125	0.09	1.30	0.42	5.60	0.71	-	-
mm	147	50.3	22.4	-	15.0	16.3	3.18	2.29	33.0	10.7	142	18.0	-	-

Tolerances (inch): 2 places: ±.03, 3 places: ±.015

Housing Material: Aluminum Alloy

Housing Finish: RoHS Clear Chemical Conversion Film
Standard offering. Paint optional.

Customizable with N or SMA Female connectors. Specify at time of order.

